



# TALL TREES

Experience the  
Tall Trees lifestyle.  
You deserve it!

Nestled in the foothills of the Pocono Mountains lies the residential apartment community of Tall Trees. A rich diversity of recreational opportunities are at your disposal. Golf at any one of the nearby private or public golf courses or relax at one of the more than two dozen lakes, ponds and streams nearby, including Lake Wallenpaupack, with its 52 mile shoreline.

---

Tall Trees residents enjoy the comforts of maintenance-free living, combined with the pleasure of a carefree lifestyle.

2000 Tall Trees Drive • Scranton, PA 18505  
(570) 961-2288 • Fax (570) 344-5366



2000 Tall Trees Drive • Scranton, PA 18505  
 (570) 961-2288 • Fax (570) 344-5366

## Features

- Quiet, secluded location
- Spacious floorplans
- Fully-equipped kitchens
- Newly renovated kitchens & baths
- Ample closet space
- Washers and dryers in select apartments
- Convenient laundry center on property
- Energy-saving thermobreak windows and sliding glass doors
- Tennis court
- Swimming pool
- Children's play area
- 24-hour emergency maintenance service
- Fitness center
- Easy access to businesses, banking, schools, and shopping

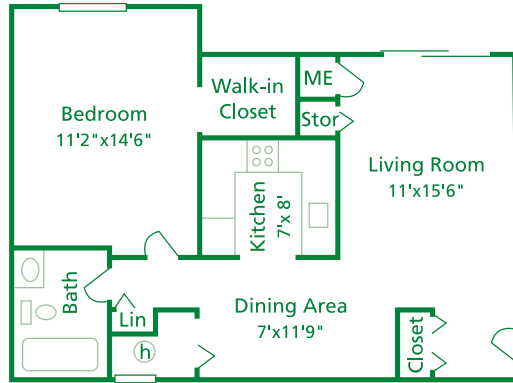

### *The White Willow*

1 bedroom, 1 bath  
 740 sq. ft.

\$ \_\_\_\_\_

### *The Aspen*

2 bedroom, 1 bath  
 845 sq. ft.

\$ \_\_\_\_\_

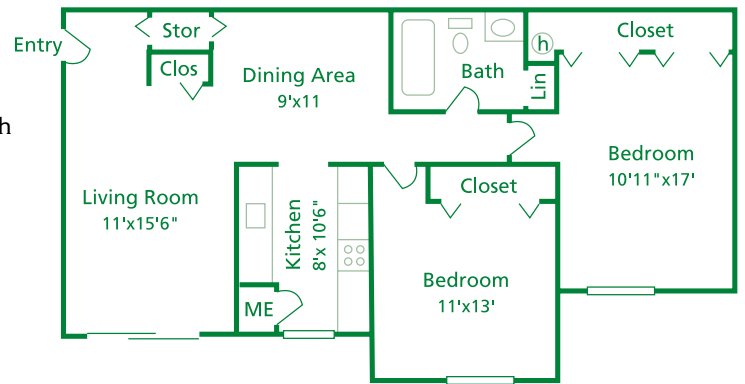

### *The Sequoia*

3 bedroom, 1 1/2 bath  
 1046 sq. ft.

\$ \_\_\_\_\_

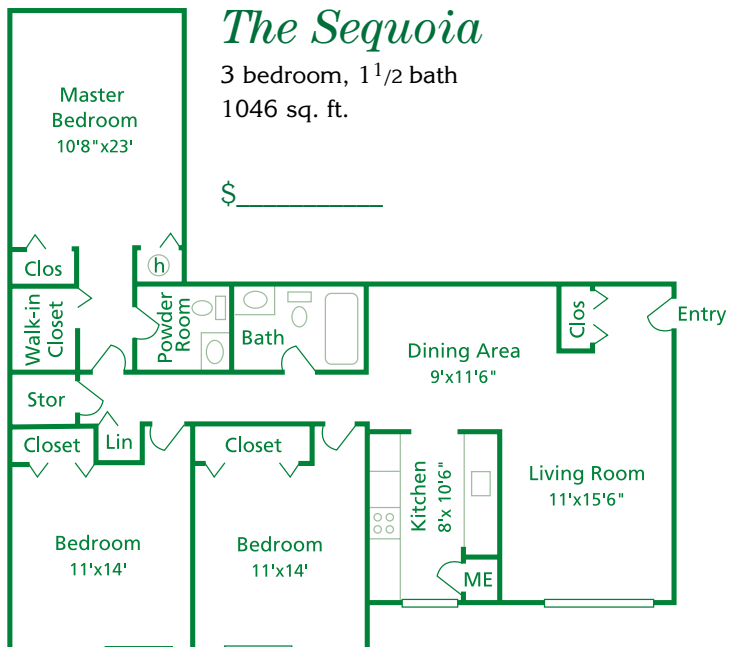



2000 Tall Trees Drive • Scranton, PA 18505  
(570) 961-2288 • Fax (570) 344-5366

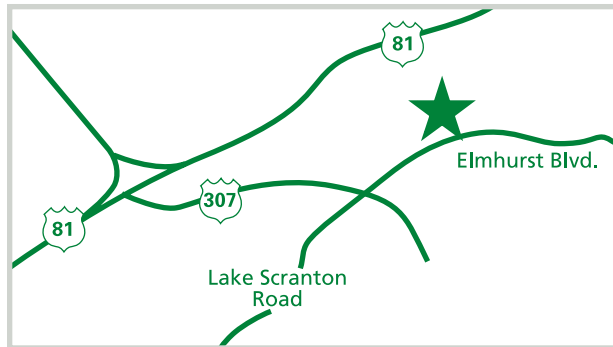

### Directions

**From I-81 South:** Take Exit 184 (Moosic Street). Turn left off exit ramp onto Route 307 South for approximately 1.2 miles. Turn left on Lake Scranton Road to Elmhurst Boulevard. Turn right to Tall Trees.

**From I-81 North:** Take Exit 184 (River Street). Turn left off exit ramp then right on Meadow Avenue to stop light. Turn onto Route 307 South and continue 1.3 miles. Turn left on Lake Scranton Road to Elmhurst Boulevard. Turn right to Tall Trees.



### Professionally Managed by RP Management, Inc.

Established in 1992, RP Management, Inc.'s mission is to provide professional and efficient management for residential apartment communities. Each RP Management community employs on-site staff, including leasing consultants and maintenance personnel, dedicated to providing high level service and maintaining resident satisfaction. As an owner-operator, RP Management concentrates on long-term ownership and continual growth while offering high quality apartment living for its residents. You will find that each community offers a distinctive way of life in apartment living and a place you will be proud to call home.

Terms and conditions subject to change without prior notice.  
Other restrictions may apply.

### Fees/Deposits

**Lease Term:** 1 year

\$\_\_\_\_\_ Security deposit

\$\_\_\_\_\_ Application fee  
(Nonrefundable)

\$\_\_\_\_\_ Holding fee  
*The holding fee holds the apartment until the application is approved. The fee will then be applied to the security deposit. If the application is rejected, the fee will be refunded.*

**Rent:** Due on or before the first of the month. Rent will be prorated if a move-in occurs after the first of the month.

**Pet Policy:** Conditional.  
See management for details.

\$\_\_\_\_\_ Pet deposit

\$\_\_\_\_\_ Nonrefundable pet fee (per pet)

\$\_\_\_\_\_ Monthly pet rent (per pet)

**Utilities:** Included in the rent are water, sewer, and trash removal.