

Offering Quality Apartment Living



Laurel *Oaks*

*The natural beauty of Laurel Oak's
wooded surroundings
creates an atmosphere of relaxing living.
Come and see for yourself
our perfect blend of location, value and
convenience.*

175 Woodlake Place • Athens, GA 30605
Tel: (706) 549-6254 • Fax: (706) 547-5188

Professionally Managed by RP Management, Inc.
www.rpmanagementinc.com

Laurel Oaks

175 Woodlake Place • Athens, GA 30605
 Tel: (706) 549-6254 • Fax: (706) 547-5188

Features/Amenities

- Spacious floor plans
- Private patios/balconies
- Washer/Dryer connections
- Fireplaces available
- Abundant closet space
- Newly remodeled kitchens and baths
- Window coverings
- Fitness center
- Swimming pools
- Tennis courts
- 24-hour emergency maintenance
- Convenient location
- On-site laundry facilities
- Ample parking
- On bus line
- Professional on-site management



The Fawn

ONE BEDROOM
 GARDEN RESIDENCE
 950 SQ. FT.

\$ _____

The Acorn

TWO BEDROOM
 GARDEN RESIDENCE
 Also available with fireplace
 1125 SQ. FT.

\$ _____

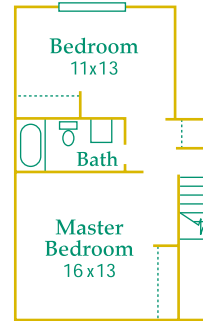
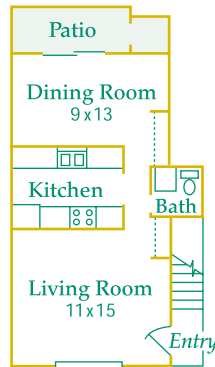
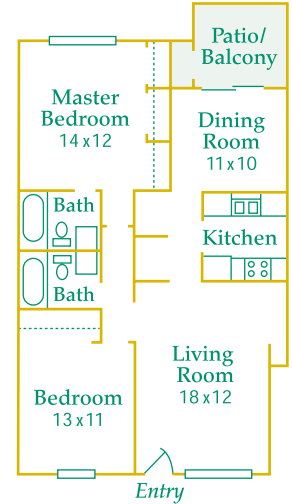

The Foliage

TWO BEDROOM
 TOWNHOUSE
 1175 SQ. FT.

\$ _____

The Glen

THREE BEDROOM
 GARDEN RESIDENCE
 Also available with fireplace
 1450 SQ. FT.

\$ _____

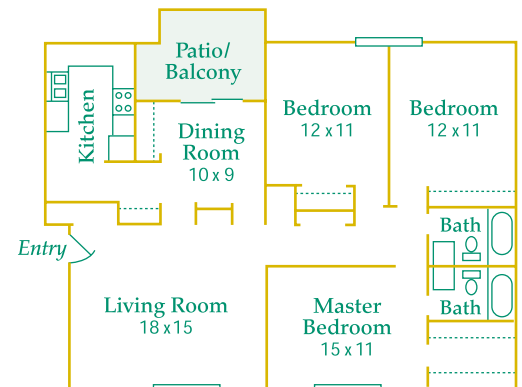

Laurel Oaks

175 Woodlake Place • Athens, GA 30605
 Tel: (706) 549-6254 • Fax: (706) 547-5188

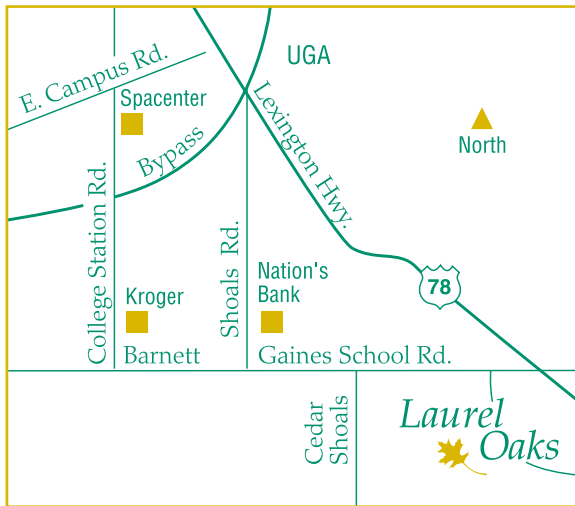

Directions

From downtown Athens, travel east on Broad Street to 78. Continue east for approximately 3 miles to the intersection of Lexington Road and Gaines School Road. Turn right onto Gaines School Road. Laurel Oaks will be on your left.



Professionally Managed by RP Management, Inc.

Established in 1992, RP Management, Inc.'s mission is to provide professional and efficient management for residential apartment communities. Each RP Management community employs on-site staff, including leasing consultants and maintenance personnel, dedicated to providing high level service and maintaining resident satisfaction. As an owner-operator, RP Management concentrates on long-term ownership and continual growth while offering high quality apartment living for its residents. You will find that each community offers a distinctive way of life in apartment living and a place you will be proud to call home.

Terms and conditions subject to change without prior notice.
 Other restrictions may apply.

Fees/Deposits

<i>Lease term:</i>	6 months (with premium) or 1 year
<i>Security deposit:</i>	\$_____
<i>Application fee:</i>	\$_____ nonrefundable
<i>Holding fee:</i>	\$_____ will hold the apartment until the application is approved. The fee will then be applied to the security deposit. If the application is rejected, the fee will be refunded.
<i>Rent:</i>	\$_____ due on or before the first of the month. Rent will be prorated if a move-in occurs after the first of the month.
<i>Water Surcharge:</i>	\$_____
<i>Pet Policy:</i>	Conditional. Inquire at leasing office.
<i>Pet Deposit:</i>	\$_____
<i>Nonrefundable Pet Fee:</i>	\$_____ per pet
<i>Pet Rent:</i>	\$_____ per month
<i>Utilities</i>	Included in the rent are pest control and trash removal. Resident is responsible for electric, cable, telephone, and water service.