

750 Gaines School Road • Athens, GA 30605
Phone (706) 353-3033 • Fax (706) 353-3436

Laurel Pointe apartments

Enjoy the beautiful surroundings,
many amenities and
maintenance-free living offered
at Laurel Pointe Apartments.
We've created an atmosphere
of relaxation that
we know you will enjoy.

Professionally Managed by RP Management, Inc.
www.rpmanagementinc.com

Laurel Pointe



apartments

750 Gaines School Road • Athens, GA 30605
 Phone (706) 353-3033 • Fax (706) 353-3436

Features/Amenities

- Newly Renovated Kitchens and Baths
- Spacious Floor Plans
- Private Entrances
- Patio/Balconies
- Washer/Dryer Connections
- Ceiling Fans
- Swimming Pool
- Tennis Courts
- Playground
- Fitness Center
- Business Center
- Community Room
- On-Site Laundry Facilities
- Picnic Area
- 24 Hour Emergency Maintenance

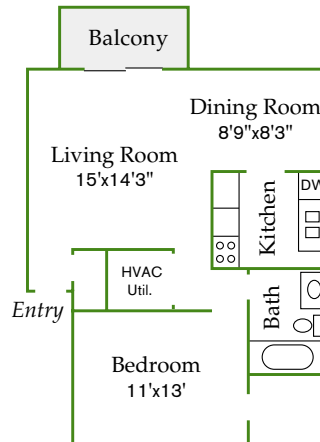

1 bedroom

one bath
 800 sq. ft.
 \$ _____

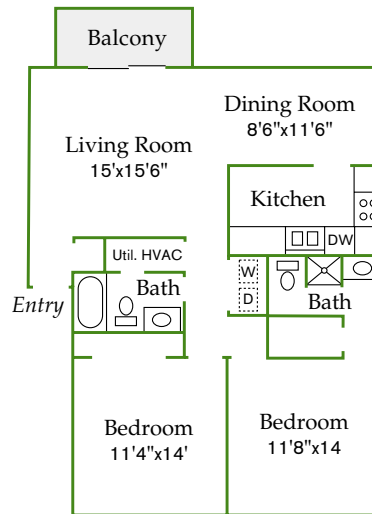

2 bedrooms

two baths
 1200 sq. ft.
 \$ _____

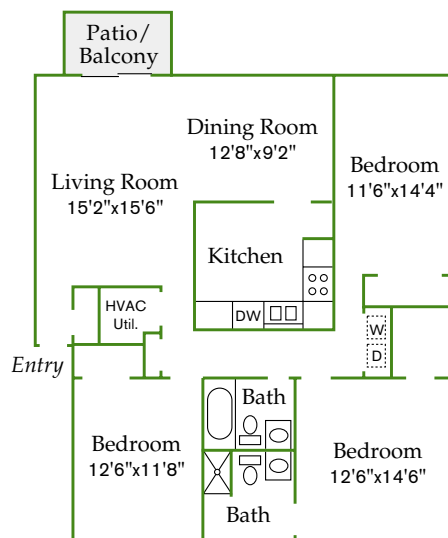

3 bedrooms

two baths
 1470 sq. ft.
 \$ _____



750 Gaines School Road • Athens, GA 30605
 Phone (706) 353-3033 • Fax (706) 353-3436

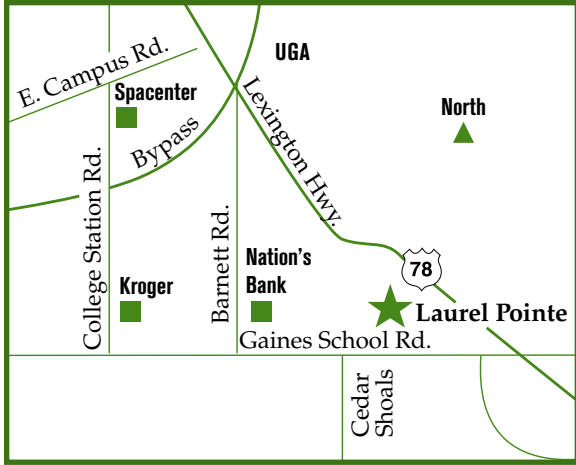

Directions

From downtown Athens, travel east on Broad Street to 78. Continue east for approximately 3 mile to the intersection of Lexington and Gaines School Road. Turn right onto Gaines School Road and travel 9/10 of a mile and Laurel Pointe will be on your right.



Professionally Managed by RP Management, Inc.

Established in 1992, RP Management, Inc.'s mission is to provide professional and efficient management for residential apartment communities. Each RP Management community employs on-site staff, including leasing consultants and maintenance personnel, dedicated to providing high level service and maintaining resident satisfaction. As an owner-operator, RP Management concentrates on long-term ownership and continual growth while offering high quality apartment living for its residents. You will find that each community offers a distinctive way of life in apartment living and a place you will be proud to call home.

Terms and conditions subject to change without prior notice.
 Other restrictions may apply.

Fees/Deposits

- Security deposit: \$_____
- Application fee: \$_____nonrefundable
- Holding fee: \$_____will hold the apartment until the application is approved. The fee will then be applied to the security deposit. If the application is rejected, the fee will be refunded.
- Rent: \$_____due on or before the first of the month. Rent will be prorated if a move-in occurs after the first of the month.
- Pet Policy: Conditional. Inquire at leasing office.
- Nonrefundable Pet Fee: \$_____per pet
- Monthly Pet Fee: \$_____
- Lease term: _____
- Utilities: Included in the rent are pest control, and trash removal. Resident is responsible for electric, cable, phone and water service.