



Colonial Garden

334 East Main Street (302) 737-1254
Newark, DE 19711 Fax (302) 737-2827

Located in the heart of Newark,
Colonial Garden Apartments offers a peaceful
location, while being convenient to area shopping
& just minutes from I-95.
Surrounded by mature trees & manicured lawns,
we invite you to enjoy the serenity
of our beautiful courtyard
hidden within our colonial style community.
At Colonial Garden, you will experience
luxury at its finest, as well as a variety of cultural
& recreational facilities nearby.



Colonial Garden

334 East Main Street
Newark, DE 19711

(302) 737-1254
Fax (302) 737-2827

The Diamond

Studio
414 sq. ft.

\$ _____

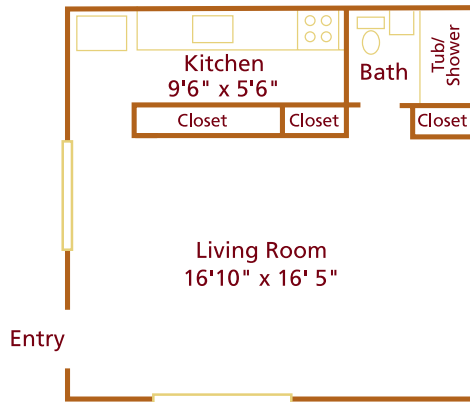

Features

- Spacious floorplans
- Natural oak kitchen cabinets
- Breakfast bar in kitchen
- Wall-to-wall carpeting
- Mini-blinds
- Lighted ceiling fans
- Individual heat & air conditioning
- Ample closet space
- Laundry facilities on-site
- 24-hour emergency maintenance service
- Unicity/DART Bus Routes
- Walking distance to shopping, restaurants & cultural activities
- Newly renovated bathrooms

The Liberty

1 Bedroom
645 sq. ft.

\$ _____



The Holly

2 Bedroom
725 sq. ft.

\$ _____

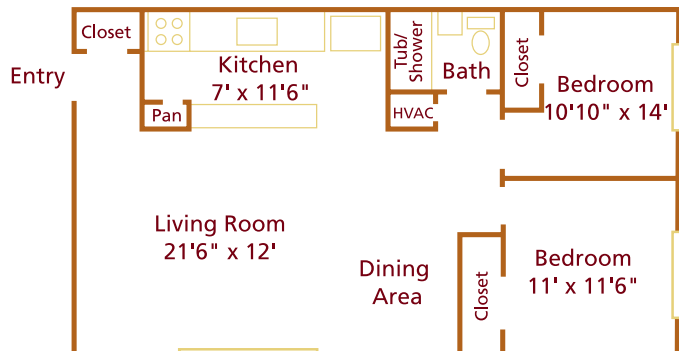



Colonial Garden

334 East Main Street (302) 737-1254
Newark, DE 19711 Fax (302) 737-2827

Directions

Follow 273W to light at East Main Street.
Continue straight through light. Turn
right into Colonial Garden Apartments.

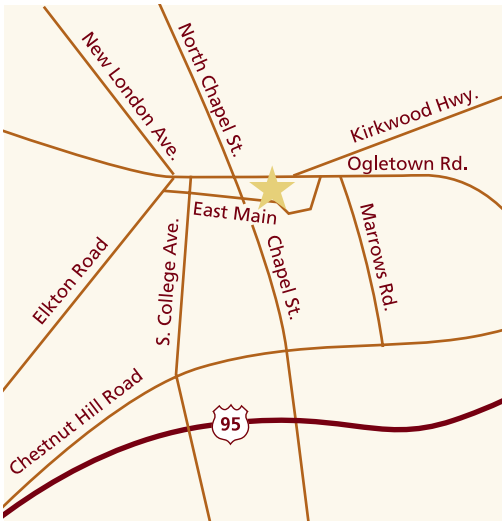
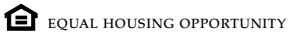

Fees/Deposits

Lease Term: 1 year

\$_____ Security deposit

\$_____ Application fee
(Nonrefundable)

\$_____ Holding fee
The holding fee holds the apartment until the application is approved. The fee will then be applied to the security deposit. If the application is rejected, the fee will be refunded.

Rent: Due on or before the first of the month. Rent will be prorated if a move-in occurs after the first of the month.

Pet Policy: Conditional.
See management for details.

\$_____ Pet deposit

\$_____ Nonrefundable pet fee
(per pet)

\$_____ Monthly pet rent
(per pet)

Utilities: Included in the rent are water, sewer, trash removal and gas heat.*

**conditional*



Colonial Garden

334 East Main Street
Newark, DE 19711

(302) 737-1254
Fax (302) 737-2827

Professionally Managed by RP Management, Inc.

Established in 1992, RP Management, Inc.'s mission is to provide professional and efficient management for residential apartment communities. Each RP Management community employs on-site staff, including leasing consultants and maintenance personnel, dedicated to providing high level service and maintaining resident satisfaction. As an owner-operator, RP Management concentrates on long-term ownership and continual growth while offering high quality apartment living for its residents. You will find that each community offers a distinctive way of life in apartment living and a place you will be proud to call home.

Terms and conditions subject to change without prior notice.
Other restrictions may apply.