



# Buttonwood

G A R D E N S

301 Friendship Avenue • Hellam, PA 17406 • Tel: 717-840-4700 • Fax: 717-840-4708



Set in the natural beauty of York County,  
Buttonwood Gardens is the perfect  
place to come home to.  
This modern community offers all of the  
features you want while our  
comprehensive service plan takes care  
of all those maintenance chores  
you don't want. At Buttonwood Gardens,  
you'll find a life made easier.

## FEATURES

- Spacious one and two-bedroom apartment homes
- Fully-equipped gourmet kitchens
- Gas stoves
- Oak Cabinetry
- Time-saving dishwasher and microwave
- Washer and dryer
- Walk-in closets
- Private patio or balcony
- Highspeed internet access available
- 24-hour emergency maintenance
- Minutes from I-83 and Route 30
- Convenient to York and Lancaster
- Close to shopping and dining
- Business services such as postal, shipping, copying, fax and notary
- Water included
- Pets welcome

### Professionally Managed by RP Management, Inc.

Formed in 1994, RP Management, Inc. is a real estate management company specializing in multi-family apartment communities. Our goal is efficient and cost-effective management with an emphasis on resident satisfaction and retention.

Each property managed by RP is fully staffed with maintenance and on-site management. The on-site employees handle leasing, maintenance, and tenant relations. All accounting and administrative functions are performed from RP's suburban Philadelphia office.

For additional information on RP Management Inc.'s outstanding apartment communities, please visit us at our website: [www.rpmgt.com](http://www.rpmgt.com).



# Buttonwood

GARDENS

301 Friendship Avenue • Hellam, PA 17406 • Tel: 717-840-4700 • Fax: 717-840-4708



## 1 Bedroom Floorplan

1 bath  
808 Square feet

\$ \_\_\_\_\_



## 1 Bedroom Floorplan

1 bath  
808 Square feet

\$ \_\_\_\_\_



# Buttonwood

GARDENS

301 Friendship Avenue • Hellam, PA 17406 • Tel: 717-840-4700 • Fax: 717-840-4708

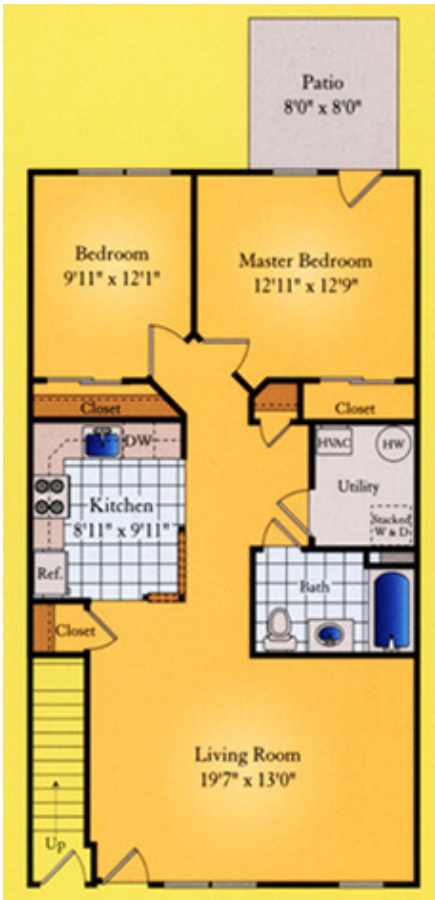

## 2 Bedroom Floorplan

1 bath  
1008 Square feet

\$ \_\_\_\_\_



## 2 Bedroom Floorplan

1 1/2 bath  
1008 Square feet

\$ \_\_\_\_\_



## 2 Bedroom Floorplan

1 1/2 bath  
1008 Square feet

\$ \_\_\_\_\_



# Buttonwood

GARDENS

301 Friendship Avenue • Hellam, PA 17406 • Tel: 717-840-4700 • Fax: 717-840-4708

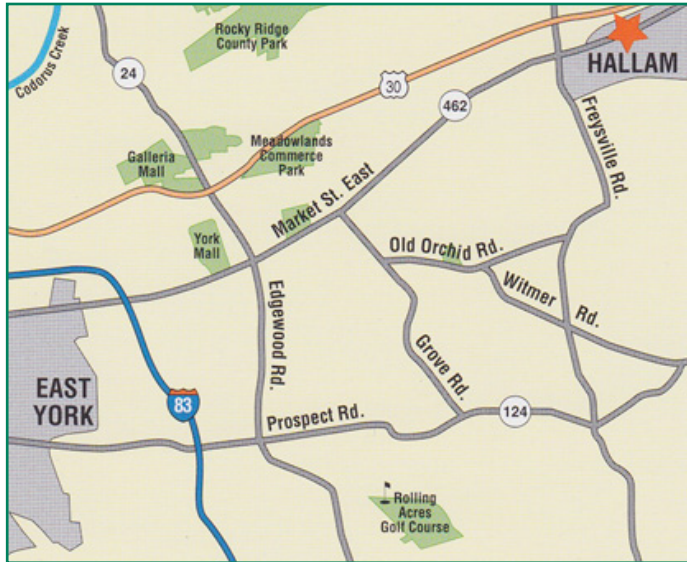

## DIRECTIONS

### *From Lancaster*

Take 30 West to Hellam Exit. Left at the end of the ramp.  
Left at first light and travel  $\frac{8}{10}$  of a mile. Make a right on  
Friendship Avenue. Leasing center will be on your left.

### *From York*

Take 30 East to Hellam Exit. Right at the end of the ramp.  
Left at first light and travel  $\frac{8}{10}$  of a mile. Make a right onto  
Friendship Ave. Leasing center will be on your left.



EQUAL HOUSING OPPORTUNITY

## FEES/DEPOSITS

*Lease Terms:* 1 year and short term

\$\_\_\_\_\_ Security deposit

\$\_\_\_\_\_ Application fee  
(Nonrefundable)

\$\_\_\_\_\_ Holding fee

The holding fee holds the apartment until the application is approved. The fee will then be applied to the security deposit. If the application is rejected, the fee will be refunded.

*Rent:* Due on or before the first of the month. Rent will be prorated if a move-in occurs after the first of the month.

*Pet Policy:* Conditional.

See management for details.

\$\_\_\_\_\_ Nonrefundable pet fee  
(per pet)

\$\_\_\_\_\_ Monthly pet rent